

Other languages?

Andere Sprachen?

D'autres langues?

Altre lingue?

¿Otros idiomas?

www.diniargeo.com



JB4QIP69K | EQUALIZATION BOX

Quick start guide

INTRODUCTION

The purpose of this guide is to familiarize the user with the installation and equalization procedure of the JB4QIP69K. We recommend that you follow the instructions carefully. Actions not indicated in this manual can compromise the proper functioning of the equipment.

TECHNICAL FEATURES

- Max input voltage: 24 V
- Max input current: 700 mA
- Max input load cell signal: 1000 mV
- Temperature effect: 50 ppm/°C
- Protection rating: IP69K
- Dimensions: 221 x 105 x 39 mm (l x w x h)
- AISI 304 / AISI 316 stainless steel

ASSEMBLY

1

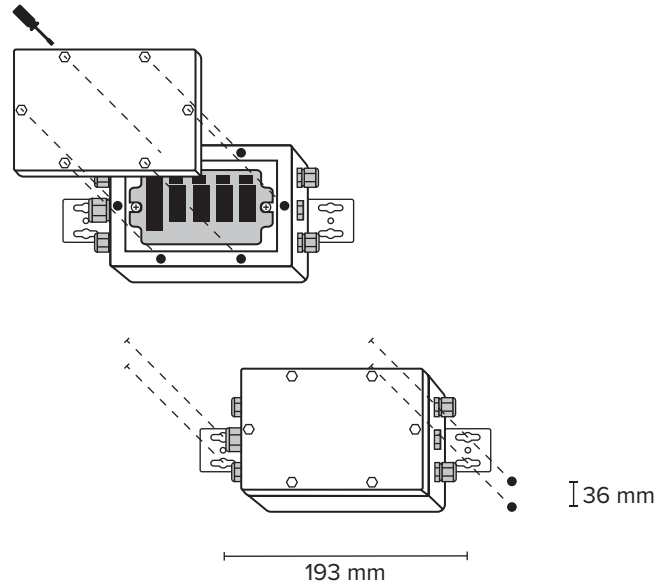

LOAD CELL CONNECTION

2

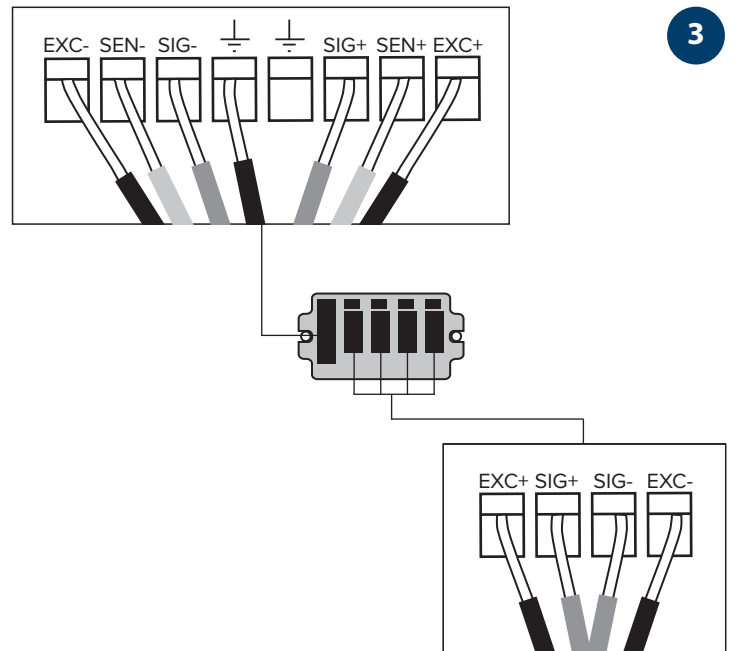
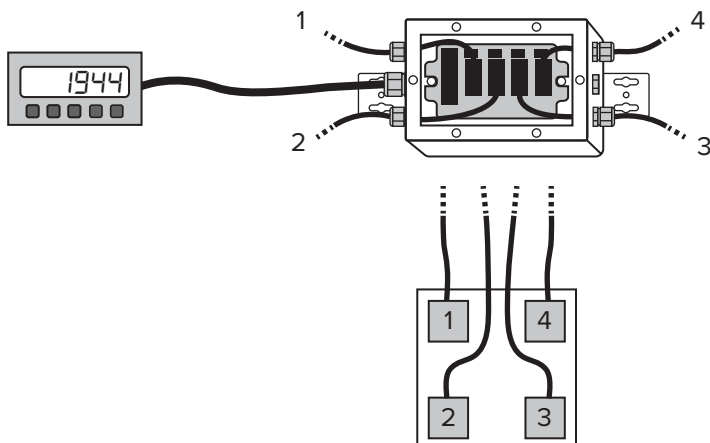

If the load cells have 6 wires, cut SEN+ e SEN- wires or connect together SEN+ with EXC+ and SEN- with EXC-.

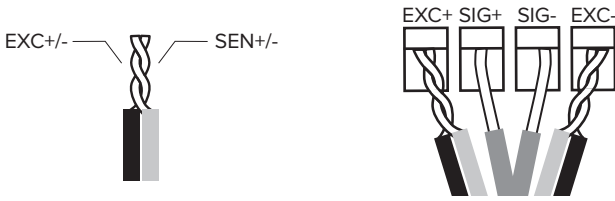

Join the shields of all load cells and connect them to the earthing connectors.

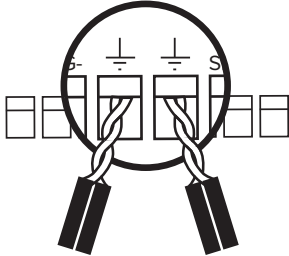

Screw all trimmers clockwise and calibrate the scale.

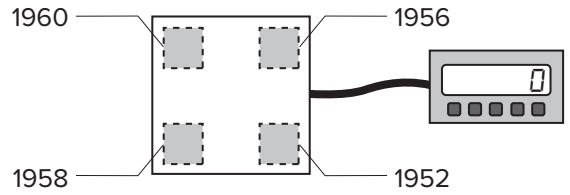

Place a weight on each load cell and identify which one of them displays the greatest weight. Adjust the trimmers on the board counterclockwise until all load cells show the same weight, as in the following example. If necessary, repeat this procedure several times for each trimmer.

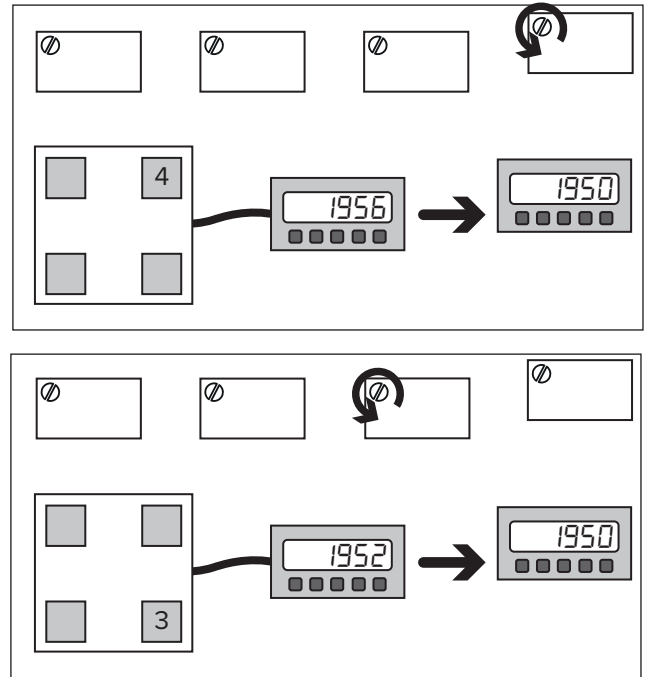
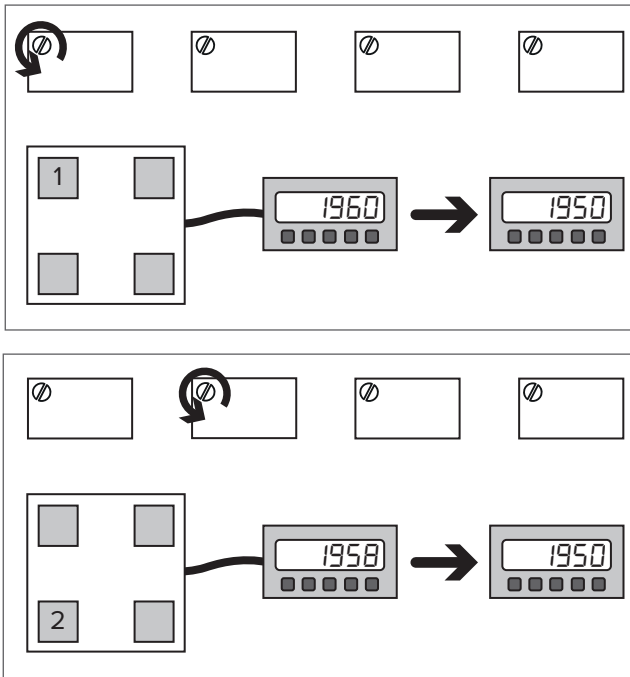

Calibrate the scale with a sample weight and verify again that all the corners display the same weight.

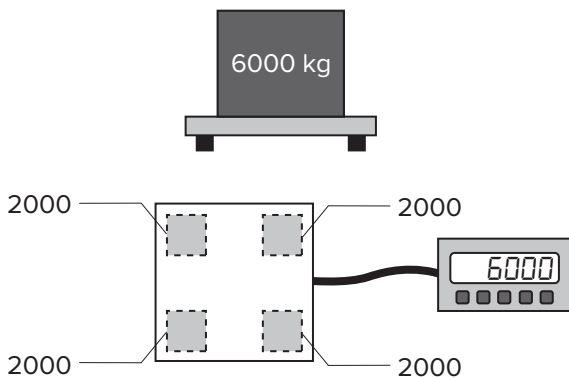

If the corners do not weigh the same, repeat the equalization procedure.

FAQ

- Can I connect only 2 or 3 load cells?

Yes, connect the load cells starting from CELL1 connector, then close the exit holes of unused load cells with the caps provided.

- How can I connect more equalization boxes to the same weight indicator?

Generally it is recommended to use an equalization box with more channels. If it is not possible, put in parallel the equalization boxes using the connector "TO CPU".

- Why can other unregulated load cells also be modified when adjusting trimmers?

As in any equalization board, trimmer adjustment alters the balance of load cells signal. Compared to the common equalization boxes on the market, Dini Argeo boxes have more sensitive trimmers, that allow for a more precise equalization and a smaller alteration of the adjacent load cells.